

Changing the default Sleep Time

Applies to: M3027mfp, M3035mfp, M4345mfp, M5025mfp, M5035mfp, & CM4730mfp

The Sleep Timer (Sleep Delay) configures the amount of time that the unit will remain active before going to a Power Save Mode (Sleep Mode). The timer starts counting after the last function has completed. If the device is not used in the amount of time designated by the Sleep Delay, the device will enter the power saving mode. The amount of time the device requires to go back into “Active” mode from a power saving mode depends on the device however it is normally only 10-30 seconds. (This is the amount of time it takes to warm up the scanner bulb. The printer portion can print from power save in < 10 seconds)

1. Click on the “Administration” Button on the front panel of the device

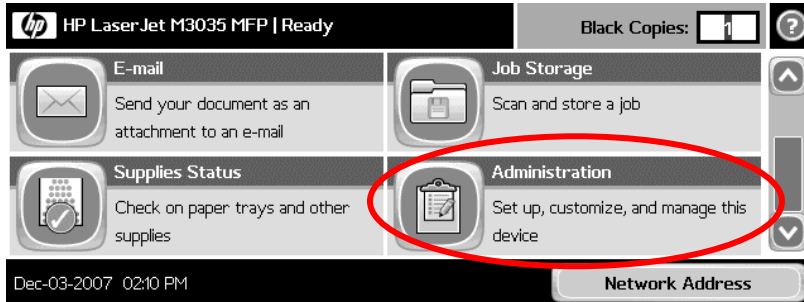

2. Select the “Time/Scheduling” Menu.

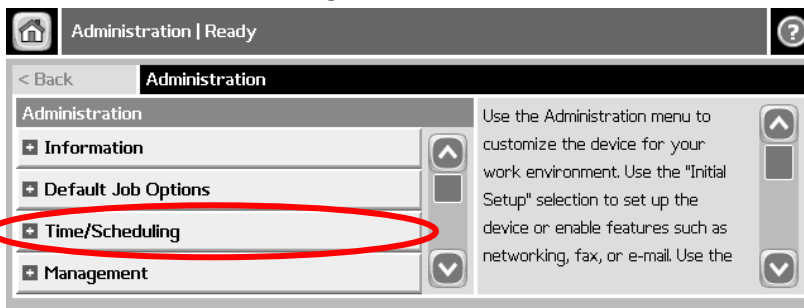

3. Select the “Sleep Delay” Sub Menu.

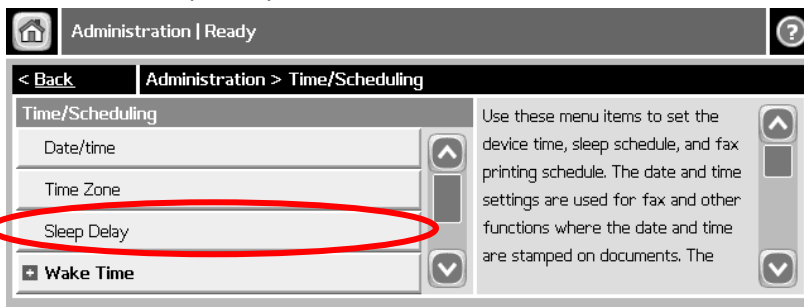

4. Select the desired Delay (in Minutes)

